

milanesi | paiusco

milanesi | paiusco design and research
米内西派斯科设计研究室

Selected Work 2024

“Re-build the Identity of the Future City.”

米内西派斯科（杭州）建筑设计事务所有限公司
N.61 Quandong, 85 Shuguang Rd., Xihu Dist, Hangzhou, Zhejiang
浙江省杭州市西湖区曙光路 85 号泉东区 61 幢
+86 153 8119 8061
pr@milanesipaiusco.com

About US 关于我们

"milanesipaiusco design and research" (formerly known as FORME, officially renamed in June 2024) was founded by Claudio Milanesi and Diego Paiusco in 2019, with offices based in Hangzhou, China, and Milan, Italy.

The diverse team comprises architects, engineers, interior designers, and researchers from various cultural backgrounds, engaging in urban planning, architectural design, interior design, and engineering research and development. They firmly believe that high-quality projects rely on design as interdisciplinary integration and are managed as rigorous construction control, ensuring enduring quality in every detail.

The firm has been included in prestigious lists such as "Position's 2023 Young Chinese Architecture Firms" and "AD100 YOUNG 2024: China's 100 Most Influential Designers". Their design projects have won the Asia Pacific Interior Design Award and the American Architecture MasterPrize, and was included in the national architectural professional academic journal "Architectural Practice". Successively been featured on globally renowned platforms such as Gooood, FRAME, Archello, Architizer, designboom, and ArchiDiaries.

Dedicated to providing diverse perspectives and solutions to address complex urban and architectural challenges, bringing more forward-looking projects to the world.

milanesi | paiusco 设计研究室（曾名 FORME 非木，于 2024 年 6 月正式更名）由 Claudio Milanesi 和 Diego Paiusco 成立于 2019 年，立足于中国杭州和意大利米兰。

多元化的团队由不同文化背景的建筑师、工程师、室内设计师和研发人员组成，主要从事城市规划、建筑设计、室内设计以及工程技术研发等业务，坚信高质量的项目依托于多学科的融合与严格的施工控制，其细节经久不衰。

事务所入选「有方 2023 年中国年轻建筑事务所」、「安邸 2024AD100YOUNG 中国最具影响力 100 位」榜单；设计项目获 APIDA 亚太区室内设计大奖、AMP 美国建筑大师奖，收录于国家级建筑专业学术期刊《建筑实践》，先后发表于 Archidaily/Gooood/FRAME/archello/Architizer/designboom/ArchiDiaries 等全球知名平台。

致力于为解决复杂的城市和建筑挑战提供多元化的视角和解决方案，为全球带来更多具有前瞻意义的实践作品。

Founding Partner
联合创始人



Claudio Milanesi
克劳迪奥·米兰内西

Claudio obtained a master's degree in Civil Structural Engineering from the University of Brescia in Italy and actively worked in the fields of art and architecture as both a painter and designer. Subsequently, he began his international career in academic research at the Design and Material Innovation Department of the University of Toronto.

In 2016, he started participating in high-quality design projects in the Asian market, including the construction supervision of the OoEli complex project (designed by the Renzo Piano Building Workshop). In 2019, Claudio founded the "milanesi|paiusco design and research" in Hangzhou, China.

Claudio 在意大利布雷西亚大学获得工程硕士学位，并以画家兼设计师的身份活跃于艺术和建筑领域。随后，他于多伦多大学的设计与材料创新系开启了他的国际学术研究生涯。

2016 年，他开始参与亚洲市场的高品质设计项目，包括天目里项目（由伦佐·皮亚诺建筑工作室设计）的建设监督工作。2019 年，Claudio 在中国杭州创立了 milanesi | paiusco 设计研究室。



Diego Paiusco
派乌斯科·迪亚戈

Diego earned a master's degree in Civil Structural Engineering from the University of Padua, Italy. Over the course of his career, he has gained extensive expertise in the design and engineering of complex building projects, structural monitoring, the restoration of historic villas, and the development of innovative and sustainable materials, primarily working across Europe and the Americas.

In 2016, he began focusing primarily on engineering consultancy and project management for renowned international firms' projects in China. In 2019, Diego co-founded the "milanesi|paiusco design and research" in Hangzhou, China.

Diego 在意大利帕多瓦大学获得了土木工程硕士学位。在他的职业生涯中，积累了涉及复杂建筑项目的设计与工程、结构监测、历史别墅修复以及创新和可持续材料开发的丰富经验，主要活跃于欧洲和美洲地区。

2016 年起，他开始专注于为知名国际公司在项目提供工程咨询和项目管理服务。2019 年，Diego 在中国杭州共同创办了 milanesi | paiusco 设计研究室。

What we care
我们关心的事

Mission
使命

"Rebuild the identity of the future city" has always been the firm's core vision, with the belief that "our buildings are not just structures - they are statements about the world we want to create."

“重塑未来城市的身份”始终是事务所的核心理念，坚信“我们的建筑不仅仅是结构——它们是关于我们想要创造的世界的陈述。”

The team draws inspiration from exploring and understanding the community, culture, and history of each project; dedicate themselves to comprehending clients' stories and aspirations, designing to shape the unique identity of each client and project.

团队通过探索、理解项目所在的社区、文化和历史来汲取灵感；致力于理解客户的故事和渴望，设计塑造每个场地、每位客户的独特身份。

Vision
愿景

Architecture is not just about beautiful symbols; it is the vision of an ideal world we wish to contribute to: each building is a flexible new model that serves urban systems, absorbs technological trends, and shapes lifestyles in cities.

建筑不仅仅是美丽的符号，它是我们希望奉献的理想世界的愿景：是一座座于城市之中服务城市系统、汲取技术趋势，塑造生活方式的灵活的新模型。

Values
价值观

Innovation, cultural respect, and social responsibility are the core values of the company's operation, guiding the principles of design and research, and demonstrating care and commitment to clients, communities, and the environment.

创新、文化尊重和社会责任是公司运营的核心价值观，是指导设计和研究的重要原则，是对客户、社区和环境的关心和承诺。



How we Work 我们如何工作

The working methodology of "milanesi | paiusco" is rooted in the interdisciplinary connection between architectural design and engineering: integrating with project objectives, continually seeking optimal solutions through mutual collaboration between the two disciplines. Through this approach, the firm is able to provide comprehensive services, from the exploration of design concepts to in-depth discussions on practical implementation.

milanesi | paiusco 的工作方法源自建筑设计与设计工程之间的跨学科联系：与项目目标相结合，不断追求两者之间相互协作的最佳方案。通过这种方法，公司能够提供全方位的服务，从对设计创意的全面探索到深入探讨如何实践和实施。

The firm firmly believes that in the process of translating design into reality, it should not be confined to a "closed" state, where each unit focuses solely on its own work, leading to information gaps and design conflicts that can only be resolved on-site during construction. On the contrary, the integration of architecture, engineering, and other related disciplines is essential to establish a holistic project workflow, ensuring optimal project quality and resilience to time constraints.

事务所坚信，在设计落地过程中不应该陷入“封闭式”的状态，每个单位只专注于自身的工作会导致信息缺失和设计冲突，最终只能在施工现场解决问题。相反，建筑、工程和其他相关专业的融合才能创建一个综合性项目流程，从而确保项目品质的最优，并能够应对时间的考验。



Approach 方法

The sustainable design approach permeates the firm's thinking about the entire project lifecycle, including processes, materials, and technology. Researching green building technologies, energy efficiency, carbon emission control, water resource management, etc: Researching ways to minimize the impact of buildings and engineering on the environment, to formulate sustainable design strategies and solutions.

可持续设计方法贯穿了事务所对项目全周期的思考，包括流程材料、工艺等。研究绿色建筑技术、能源利用效率、碳排放控制水资源管理等议题，研究如何最大限度地减少建筑及工程对环境的影响，以制定符合可持续发展原则的设计策略和解决方案。

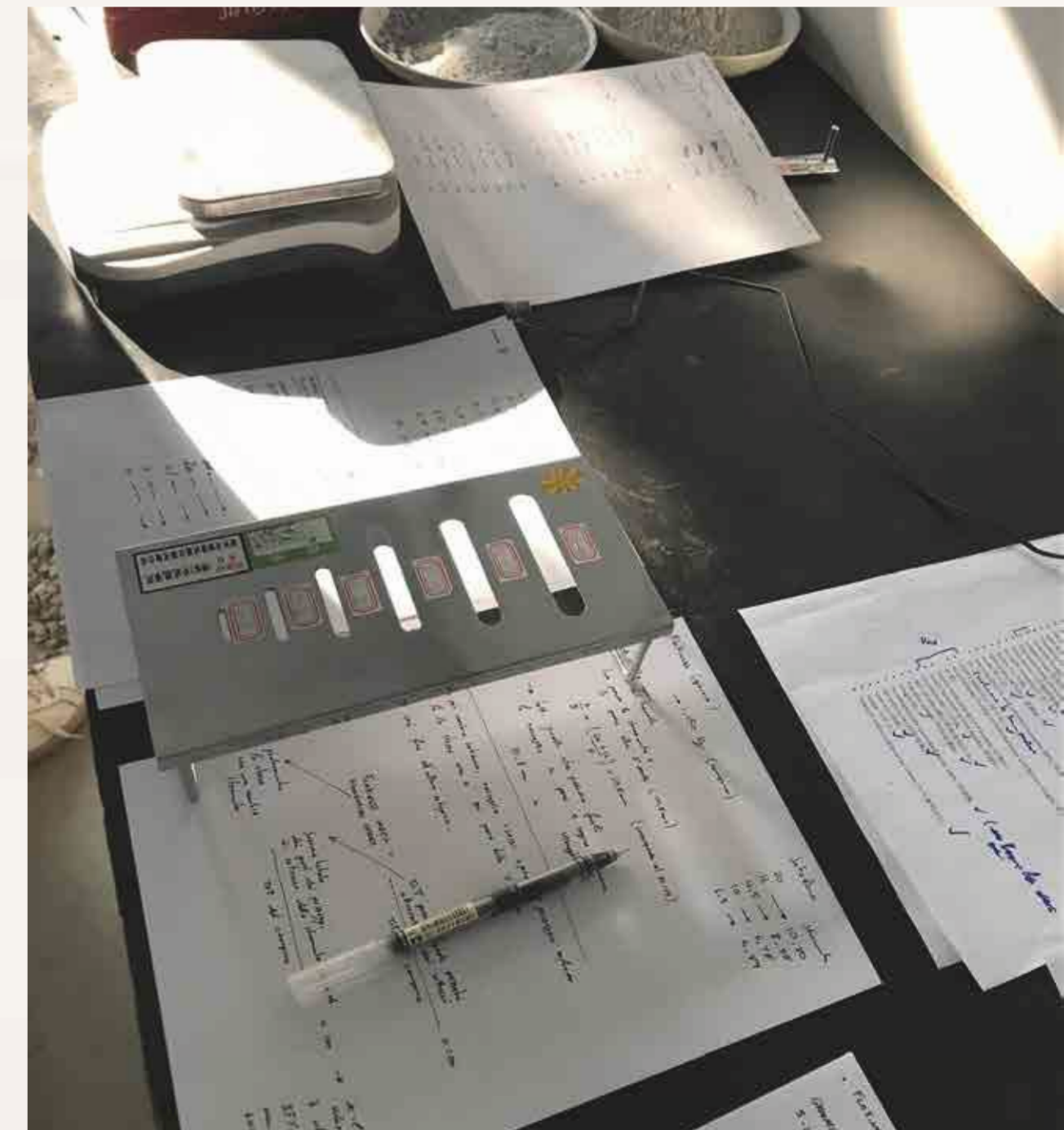

milanesi paiusco | FORME

"milanesi | paiusco" specializes in the field of architectural design, dedicated to creating forward-thinking and identity-driven architectural works and urban spaces.

milanesi | paiusco 专注于建筑设计领域，致力于打造前瞻性和身份性的建筑作品和城市空间。

As its independent research arm, "FORME" engages in the exploration and study of cutting-edge topics in architecture and engineering through planning, experimentation, analysis, and collaboration with academia, industry partners, and professional organizations. It provides theoretical support and practical guidance to the designs of "milanesi | paiusco", driving advancements in the field of art and design.

而 "FORME" 作为其旗下独立的研究部门，通过策划、实验和分析等方式，以及与学术界、行业合作伙伴和专业机构的交流探索研究建筑和工程领域的前沿议题，为 milanesi | paiusco 的设计提供理论支持和实践指导，推动设计和艺术领域的发展。



Technological innovation and material research
技术创新和材料研究



Sustainability research
可持续性研究



Social education
社会教育



Project planning and development strategy
项目策划和发展战略

Technological innovation and material research

技术创新和材料研究

Focused on developing new architectural materials, construction techniques, and digital design tools. "milanesi | paiusco" through experimentation and testing in FORME-Lab, the suitability and effectiveness of these new technologies and materials can be evaluated and applied to milanesi|paiusco's design practice to achieve innovative design solutions.

专注于开发新的建筑材料、施工技术和数字设计工具。通过 FORME-Lab 的实验和测试，可以评估这些新技术和材料的适用性和效果。并将其成果应用于 milanesi | paiusco 的设计实践中，以实现创新的设计解决方案。



Over the past century, concrete has been a cornerstone of the architectural world, yet it has now become a highly controversial topic in the environmental field. The study of different types and functions of concrete is currently the studio's core research focus, with its founders dedicating themselves to the exploration of this material since their academic careers.

在过去的百年间，混凝土一直是建筑界的主角，而如今却成为环境领域备受争议的话题。不同类型和功能的混凝土是工作室当前最核心的研究课题，创始人从学术生涯起便专注于这一材料的探索。

Thus, pursuing innovation in this field is not only about meeting clients' technical and aesthetic requirements in our consulting services but also reflect the studio's commitment to advancing design and improving the environment, embodying a sense of social responsibility.

因此，在这一领域寻求创新，不仅是我们在提供咨询服务中满足业主对技术与美学的要求，也代表了工作室在推动设计进步与改善环境方面所肩负的社会责任。

We adopt an interdisciplinary approach to study the diverse characteristics of concrete, from its chemical composition, mechanical properties, and feasibility to its architectural expression and its social and environmental impacts. Over time, our research directions and goals have continued to evolve and expand. Based on this subject, our project studies include the following methods:

我们以跨学科的方法研究混凝土的多种特性，从其化学成分、力学性能、可行性，到其在建筑中的表现意义及对社会和环境的影响。随着时间推移，我们的研究方向和目标也在不断演变和拓展。围绕这一课题，我们的项目研究包括以下方法：

- Design interpretation 设计理解
- Feasibility studies 可行性研究
- Sample testing 样品测试
- Design solutions 设计方案
- Carbon reduction strategies 碳减排策略
- Visual prototype production 视觉样板制作
- Quality control process development 品控流程制定
- On-site management and execution 现场管理与执行

Sustainability research

可持续性研究

Addressing the sustainability and environmental protection aspects of architectural design, we research green building technologies, energy efficiency, carbon emission control, water resource management, etc. Researching ways to minimize the impact of buildings and engineering on the environment, in line with principles of sustainable development, to formulate sustainable design strategies and solutions.

关注建筑设计的可持续性和环境保护，研究绿色建筑技术、能源利用效率、碳排放控制、水资源管理等议题，研究如何最大限度地减少建筑及工程对环境的影响，以制定符合可持续发展原则的设计策略和解决方案。



We consistently remind ourselves of the significant responsibility that our work entails towards society from the cultural and usability aspects of the designed spaces. As a result, our firm is compelled not only to operate with the utmost professional ethics but also to scrutinize and investigate the current issues in the world and how our sector is implicated. We firmly believe that every project and collaboration must demonstrate the appropriate level of modesty and respect towards current issues, transforming the project from a mere aesthetic exercise into an effective communication tool.

我们时刻提醒自己，从空间功能及文化角度，我们所做的工作对社会至关重要。因此，我们不仅必须秉持高度的职业道德精神，还要仔细审查当代全球性的问题，以及我们所处的行业是如何作用其中的。

An ecologically and energetically conscious design represents a fundamental aspect of the protection and respect of the places in which we live. Our work therefore aims to combat the environmental problems affecting our planet through a holistic approach that touches on issues such as the reduction of CO2 emissions during the construction process, the use of renewable resources and energy, limiting water and energy consumption, the use of zero-kilometer and/or recycled raw materials, etc.

我们坚信，每一个项目和合作都必须保持对当前问题适当的谦逊和尊重，将项目从单纯的美学探究转化为有效的沟通工具。具有生态和能源意识的设计是保护和尊重我们生活的家园的基本方面。因此，我们的工作旨在通过综合型方案解决存在的环境问题，减少施工过程中排放的二氧化碳、使用可再生资源 and 能源、限制水和能源消耗、使用可回收原材料等。



Social education

社会教育

我们深信教育与知识传播的重要性，通过技术培训提升一线人员的专业技能与素养，助力优化建筑行业的质量与安全水平，培养能够适应行业发展需求的技术人才。

同时，与业内设计师分享最新技术进展与成功案例，共同推动可持续理念的实践。我们希望不仅满足行业的当前需求，更以创新与责任引领行业迈向更高质量和更安全的未来。



We firmly believe in the importance of education and knowledge dissemination. Through technical training, we enhance the professional skills and competencies of frontline personnel, contributing to the improvement of quality and safety standards in the construction industry and cultivating talent capable of meeting the evolving demands of the sector.

At the same time, we share the latest technological advancements and successful case studies with industry designers, jointly promoting the implementation of sustainable concepts. We aspire not only to meet the current needs of the industry but also to lead it toward a future of higher quality and greater safety with innovation and responsibility.



Consulting project
咨询项目



Grand Canal Museum/ 中国京杭大运河博物院二期
Design by Herzog & de Meuron



OoEli (Hangzhou)/ 杭州天目里
Design by Renzo Piano Building Workshop



DQSW Headquarter/ 郑州清德实业产业孵化园
Design by Neri&Hu Design and Research



Selected design project
精选设计项目

2023
- 2024

EX-PIAGGIO Area Urban Design(Italy)
前比亚乔地区城市更新 (意大利)

2020
- 2024

Tederic International Center(Hangzhou)
泰瑞国际园区 (杭州)

2024
-

Yiji Headquarters parks(Hangzhou)
一季时装总部园区 (杭州)

2022
-2023

Villa Moon(Hangzhou)
月下餐厅 (杭州)

2023
-2024

Hangar 35 Moto-Pub(Ningbo)
Hangar 35 摩托俱乐部 (宁波)

2024

Underbridge Station(Hangzhou)
桥下驿·渔跃橙桥 (杭州)

Italy EX-PIAGGIO Area Urban Design

意大利·前比亚乔地区城市更新

2023 - 2024

Site Area - 40,000 sqm
Gross Floor Area - 58,500 sqm

占地面积 40,000 平方米
建筑面积 58,500 平方米

Scope of Work
Main Designer

工作范围
项目设计

Project status
Completed

项目进展
已完成



In August 2023, "milanesi | paiusco" was invited by the municipality of Finale Ligure, in the province of Savona, Liguria Region, Italy, to participate in the tender for the redevelopment of the former Piaggio industrial area in Finale Ligure. After several rounds of evaluation by the mayor and expert committees, "milanesi | paiusco" successfully won the bid for the project.

2023年8月，milanesi | paiusco 受意大利利古里亚大区萨沃纳省菲纳莱·利古雷市政府邀请，参与了前比亚乔工业区再开发项目的招标。在市长和专业委员会的多轮评审后，milanesi | paiusco 成功中标该项目。

Given the project's unique geographic location and hydrogeological risks, the redevelopment is not led by a single company, but is a complex project involving collaboration among multiple government agencies, design firms, consulting teams, and developers. Among them, "milanesi | paiusco" is responsible for the overall planning, ensuring the successful transformation of this former industrial area into a multifunctional urban landmark.

鉴于项目的特殊地理位置和水文地质风险，此次再开发并非由单一公司主导，而是由多个政府机构、设计公司、咨询团队和开发商共同合作完成的复杂项目。其中，milanesi | paiusco 负责总体规划，确保这一前工业区能够成功转型为集多功能于一体的城市新地标。

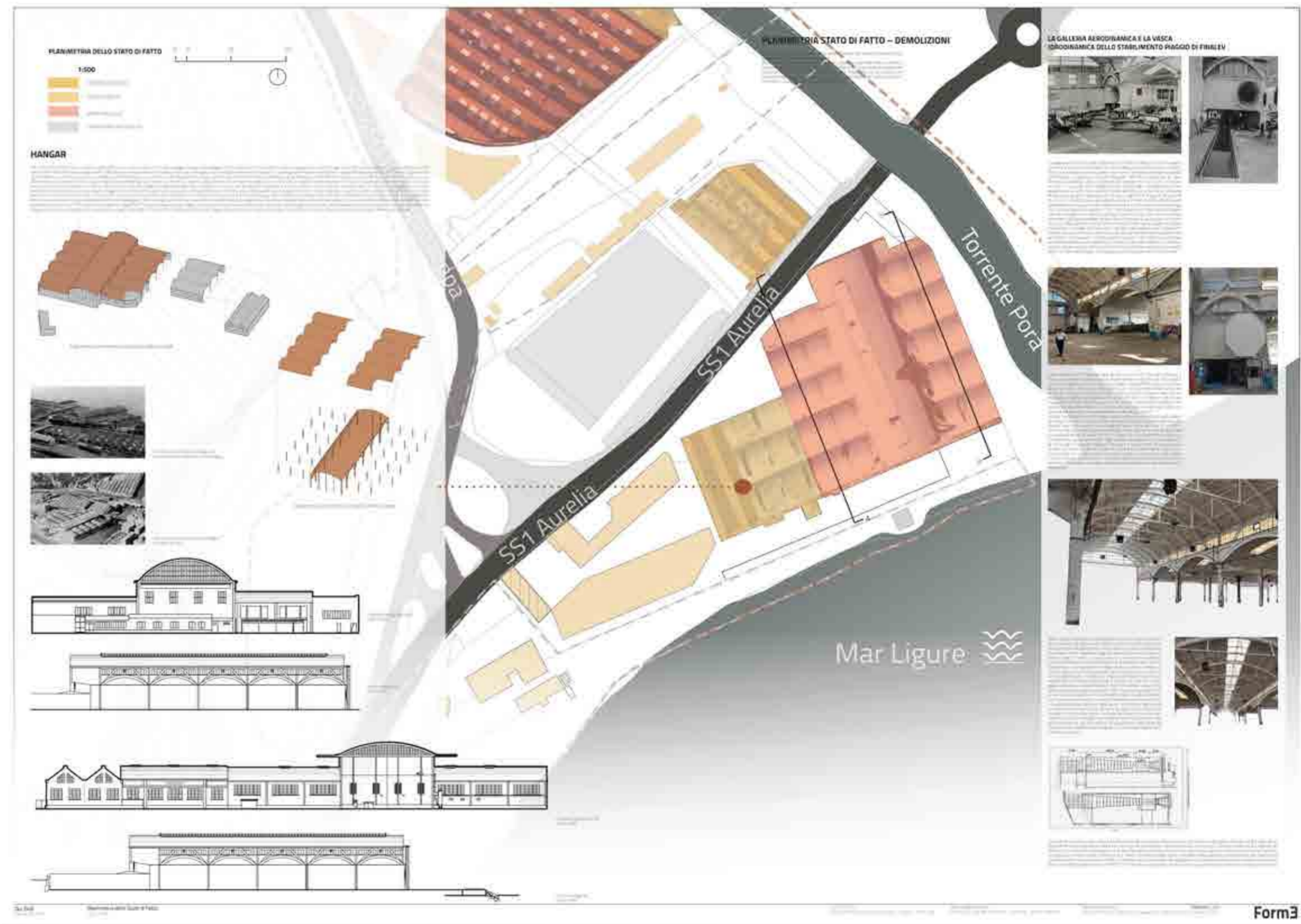
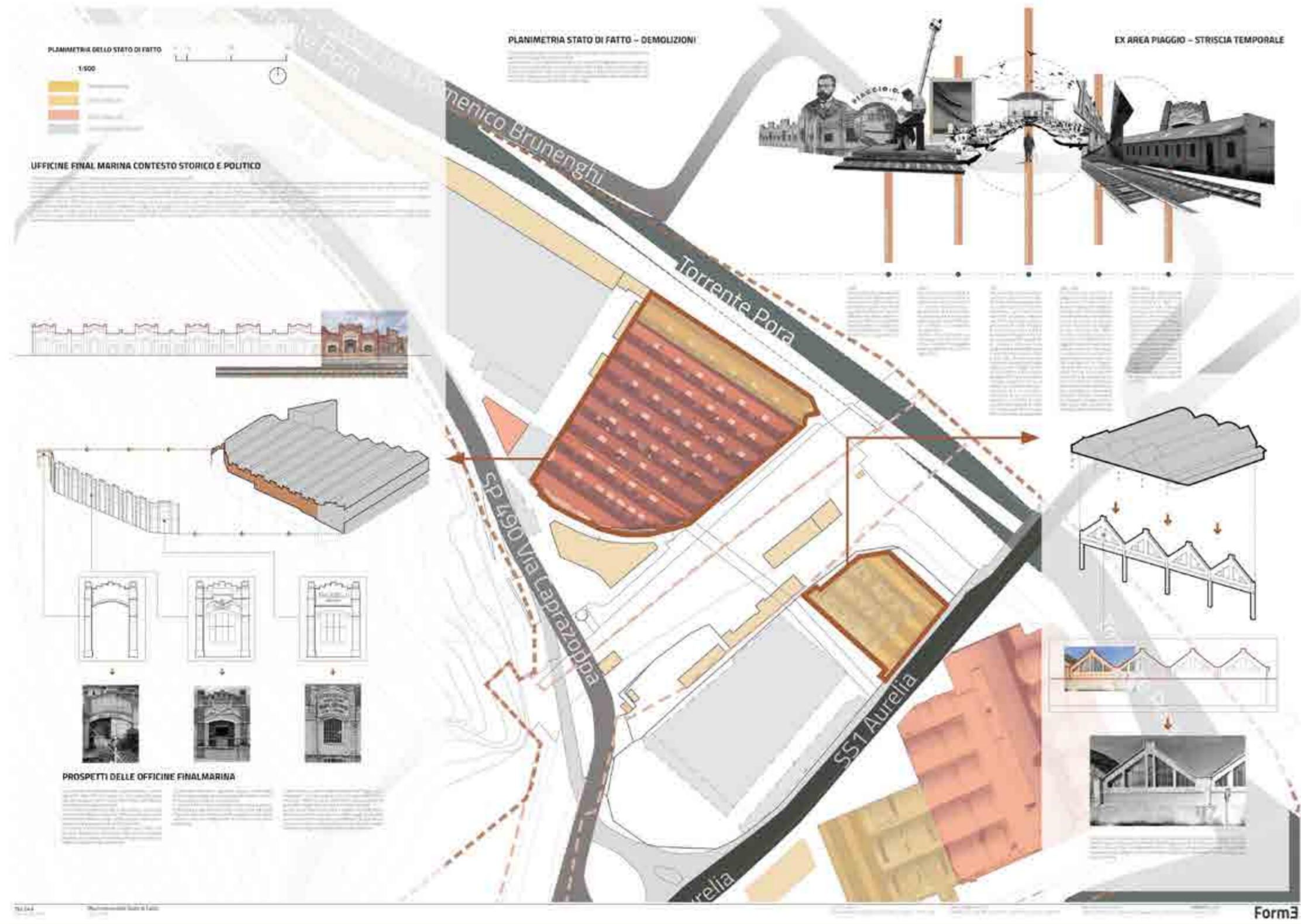

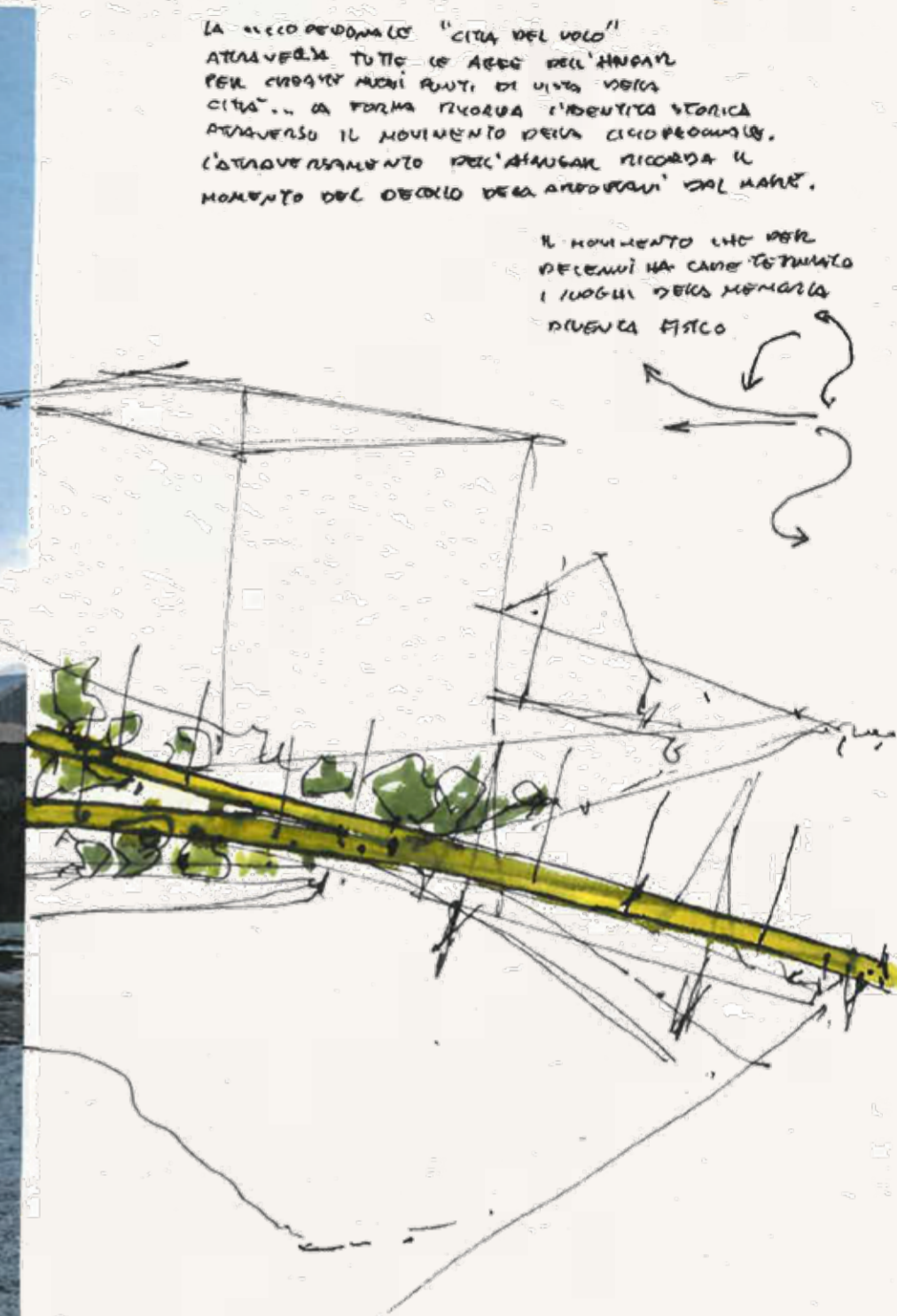

LA NUOVA PEDANA "CITA DEL VOLO"
 ATTRAVERSA TUTTE LE ARCE DELL'ANCIANO
 PER CROCIARE I LUOGHI PIU' DI UNO DELLA
 CITA... LA FORMA RICORDA L'IDENTITA' STORICA
 ATTRAVERSO IL MOVIMENTO DELLA CROCIATA
 L'ATTRAVERSO DEL'ANCIANO RICORDA IL
 MOMENTO DEL DECIDIO DELLA ANCIANO' DAL MARE.

IL MOMENTO CHE VORRE
 DEDICARE HA CARATTERI
 I LUOGHI DELLA MEMORIA
 NUOVA FISCA

"BANGAL SI ACCENDE" CON
 LE NUOVE FONTI DI TRAVERSO
 LA "TRA SPERANZA DELLE SUPERSTIZI"
 CHE MOSTRANO LE ATTIVITA
 AL SUO INTERNO... LE ATTIVITA
 NON SONO PIU' SEGRETE... INTERAMENTE
 CON LA NUOVA IDENTITA' DEL PRODOTTO
 DIVENTANO PARTE DELLA COLLETTIVITA'
 DI FINALE CROCIATA... DIVENTANO MEMORIA
 STORICA DA VIVERE INSIEME.

ZONA
 DEDICATA
 A PARCO

ABSOLUTUM
 COLTI
 INTERNO

PARCATA DI
 INTERESSE
 STORICO

FERRARIE

POSTATO
 A NUOVO

MUSEO
 CITA
 DEL VOLO

COLLEGGIAMENTO
 PEDONALE
 CITA

RIUNIFICAZIONE
 DEL TRATTO
 DELL'ANCIANO
 DALLA VECCHIA
 POSTAZIONE

VALUNA DOTTI
 E' AREA DI
 INTERVENTO

BANGAL
 PIANO

A) RESIDENZE LUSSE
 VICINA MARE FRONT
 MARE

B) RESIDENZE
 SOTTO MARE
 MARE

DISTA
 FINALE DEL
 ANCIANO

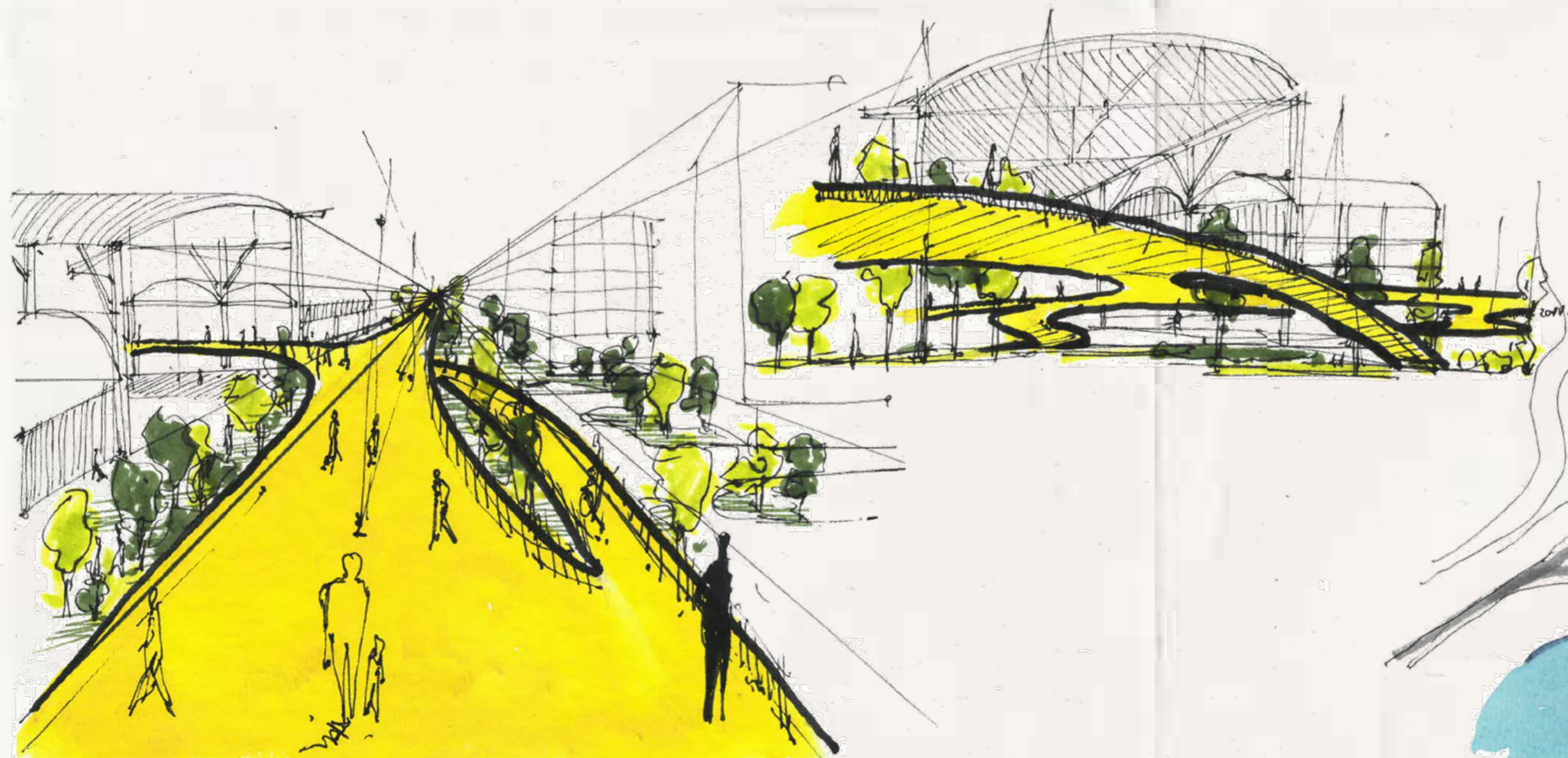

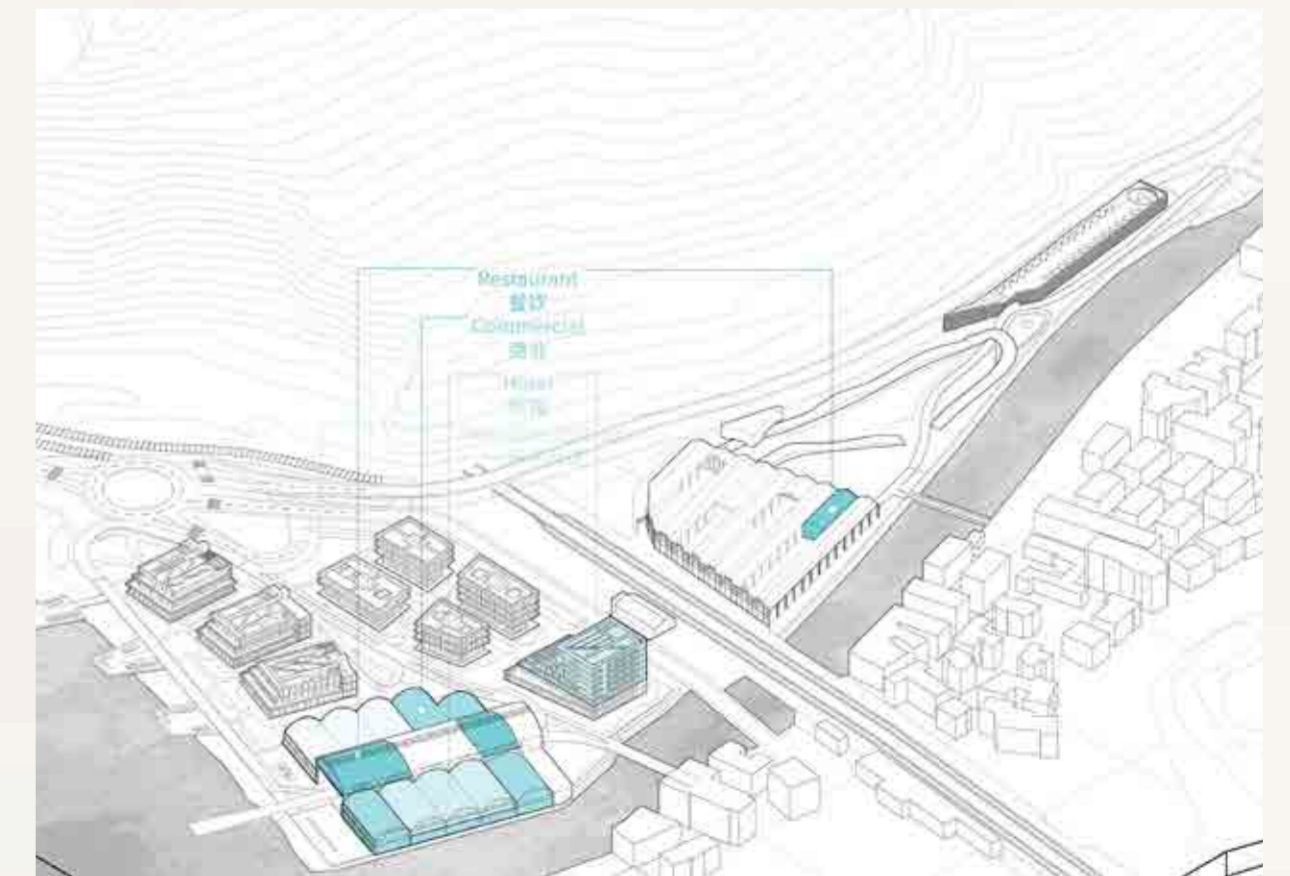
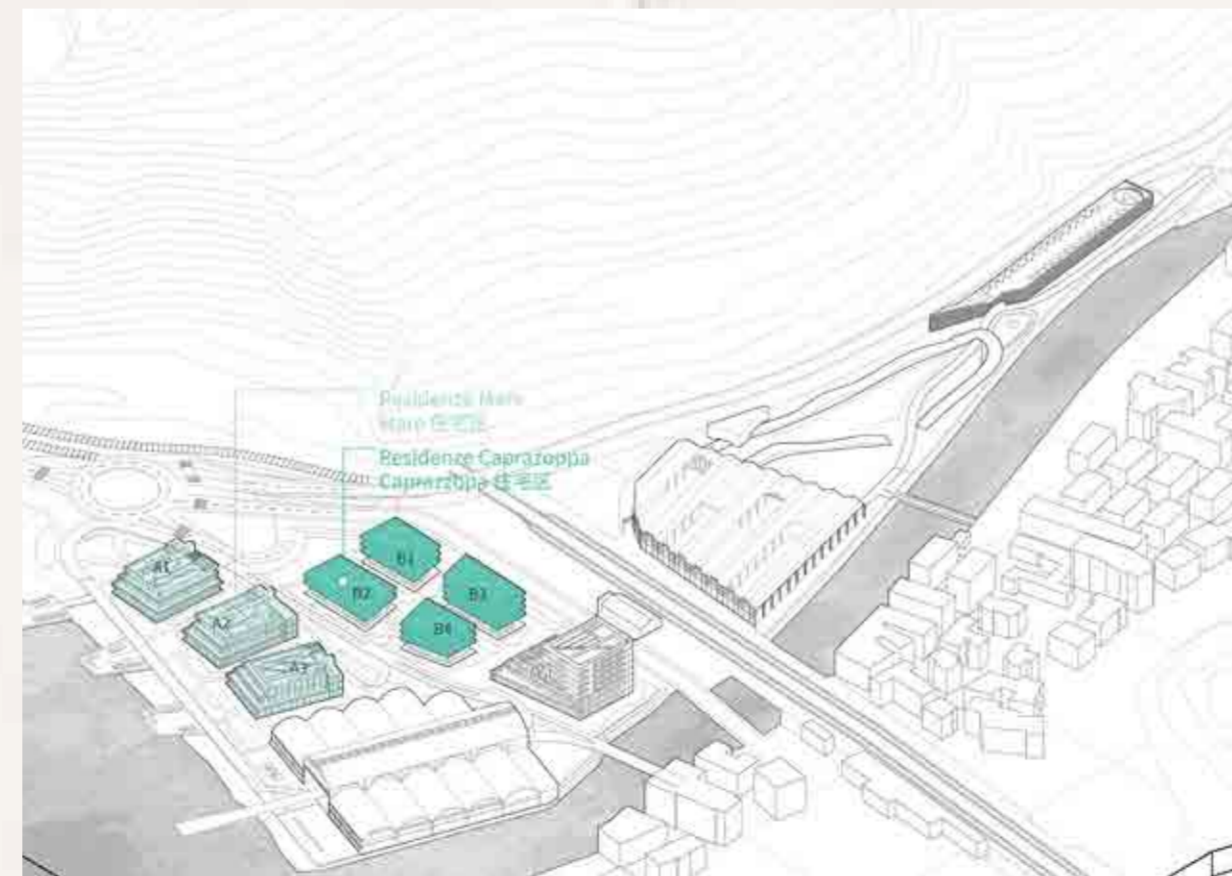
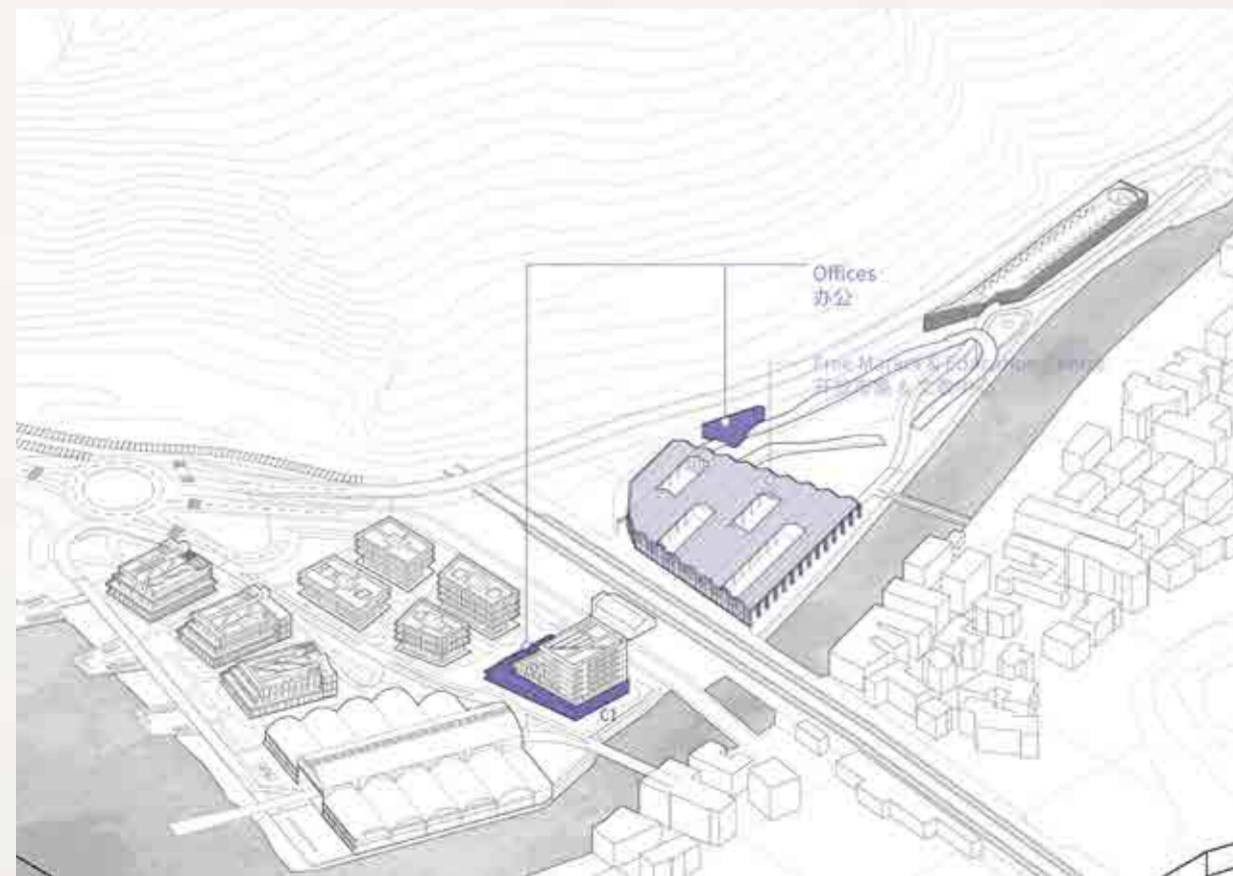
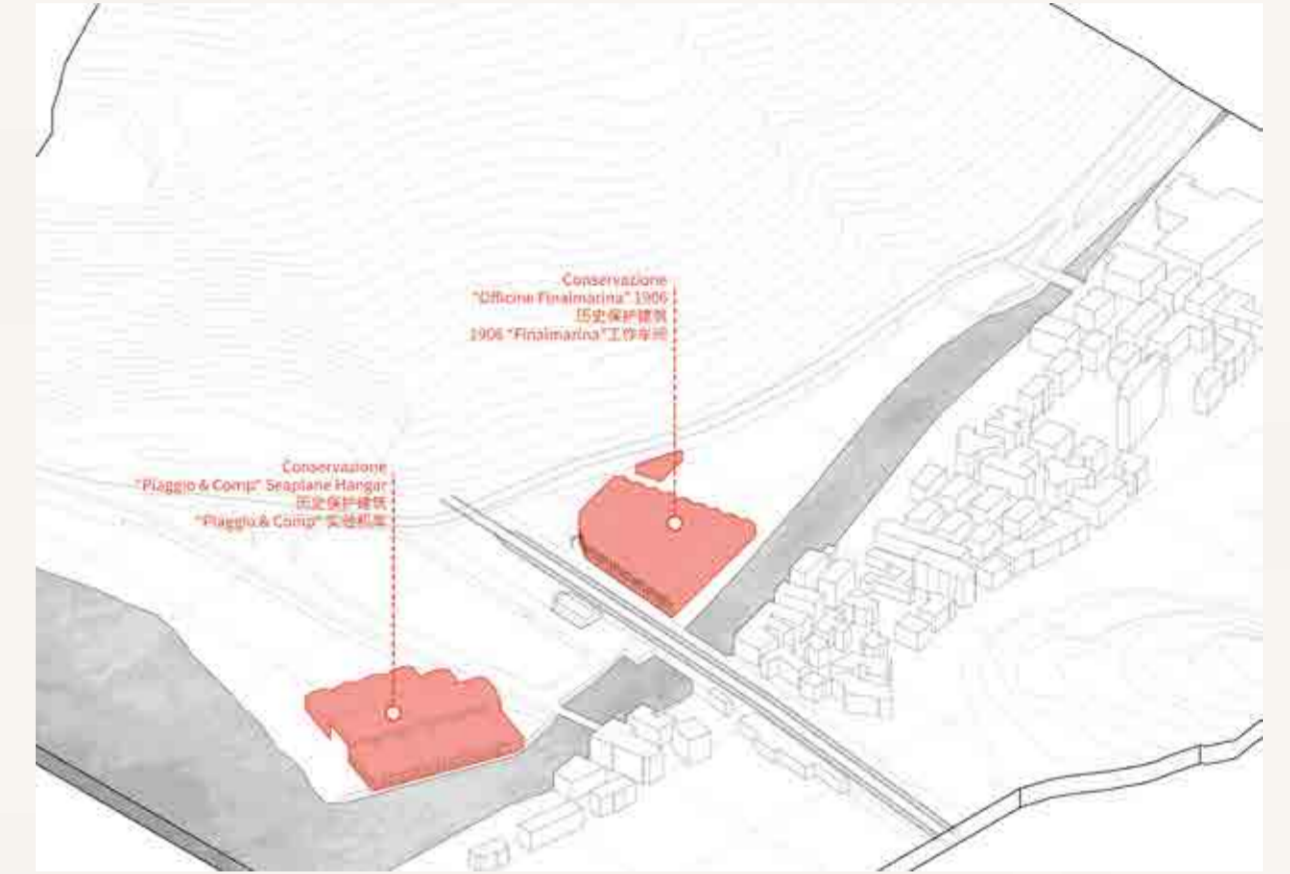
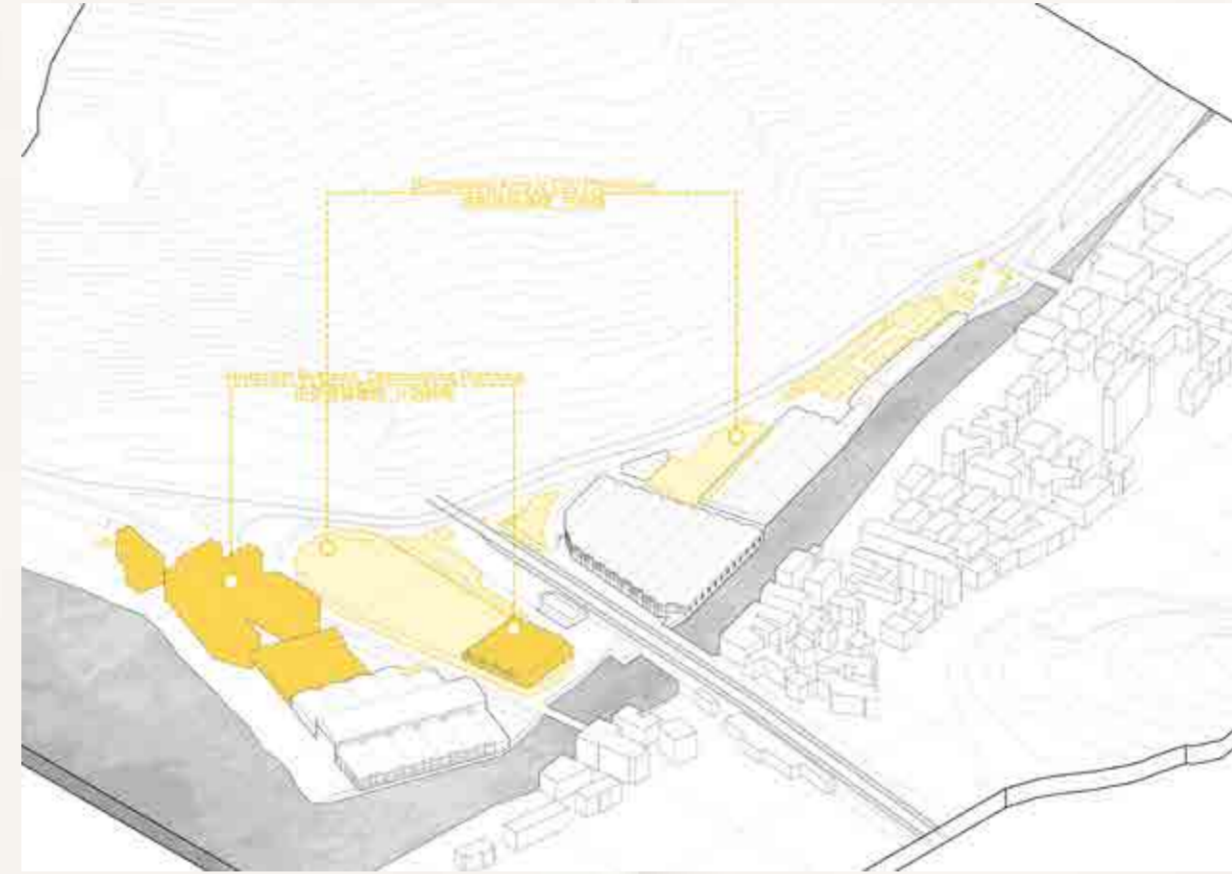

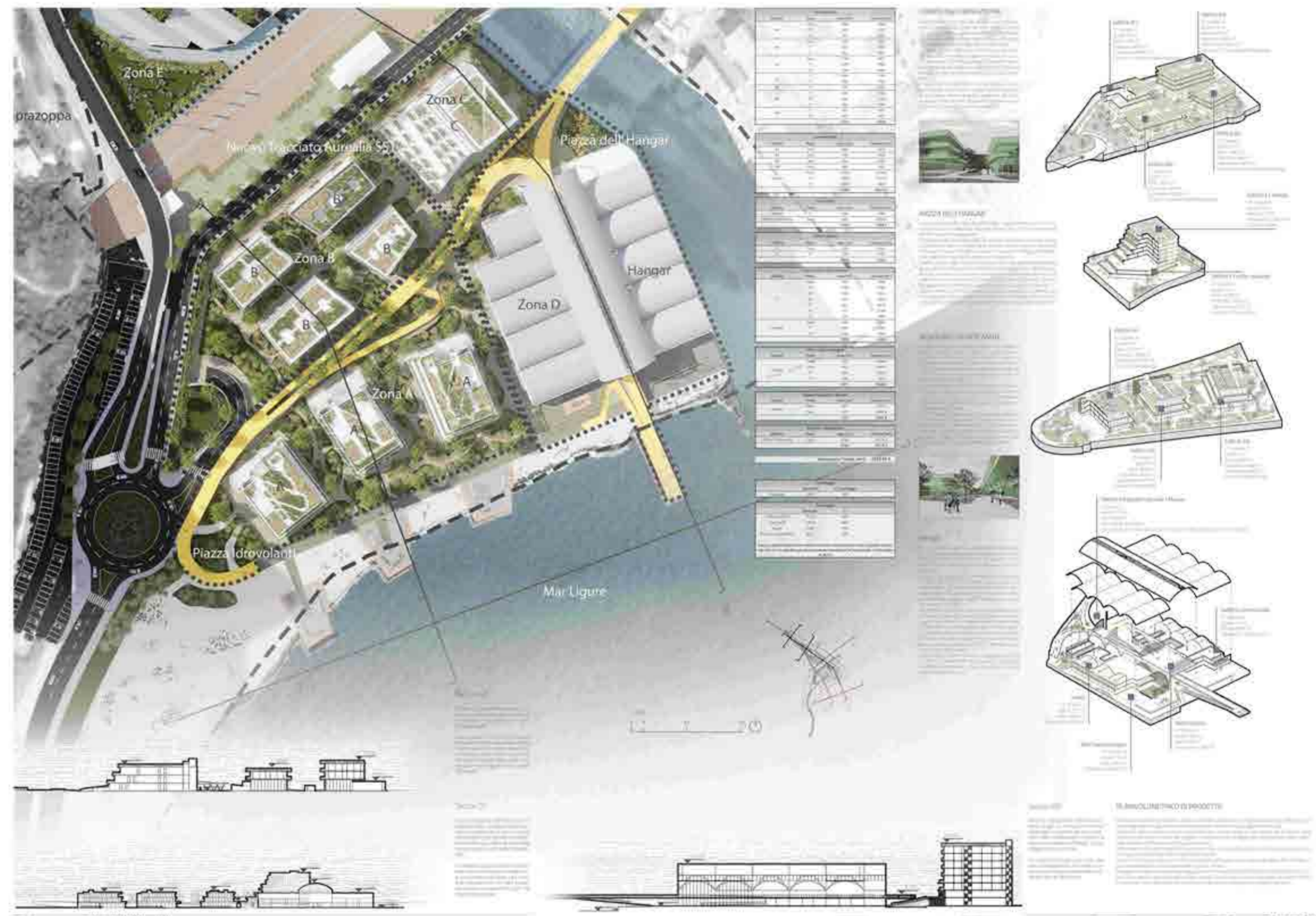
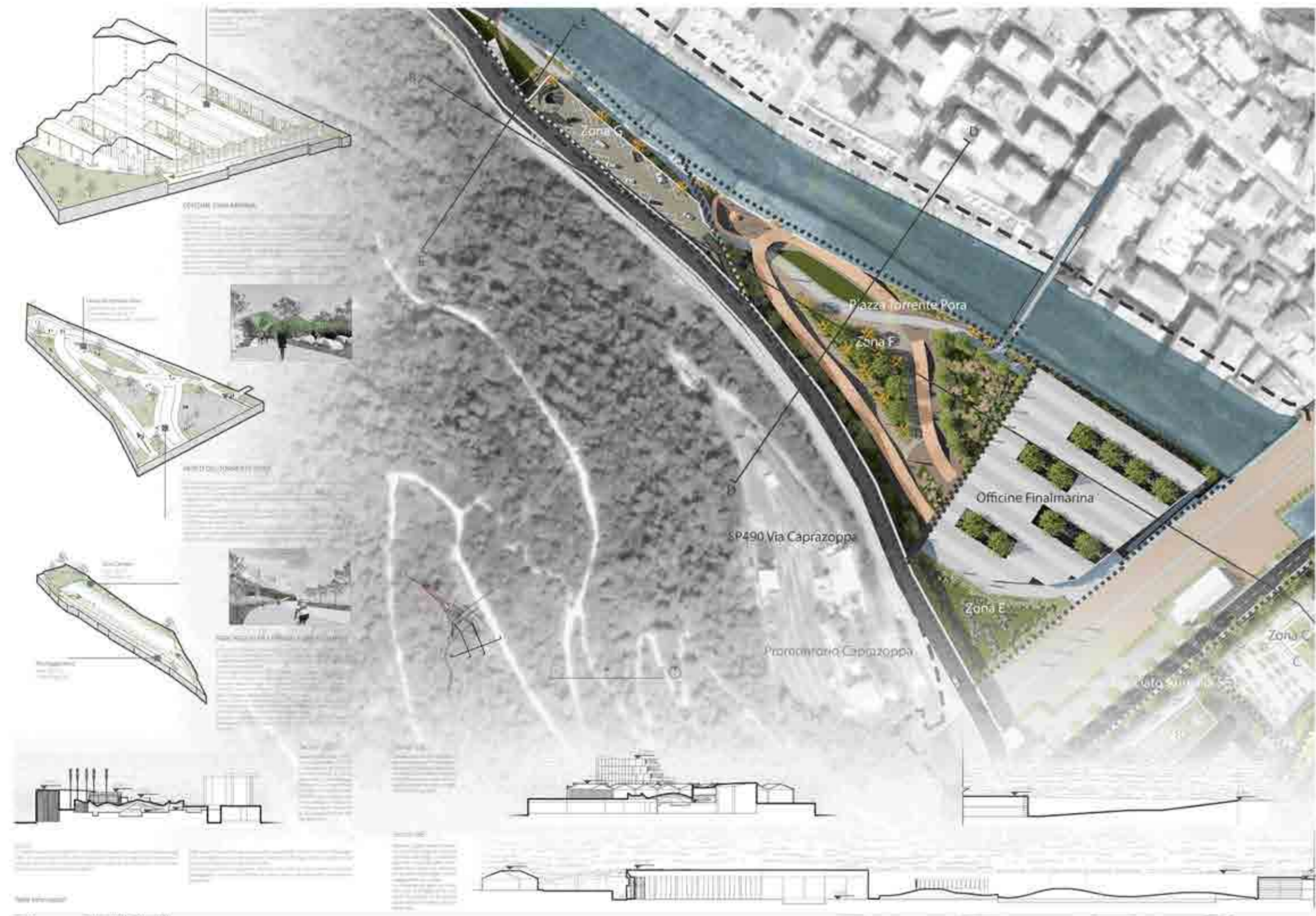



Hangzhou Tederic International Center

杭州·泰瑞国际园区

China's manufacturing industry is emerging on the global stage with an innovation-driven image, steadily transitioning from "Made in China" to the upgraded "Chinese brand." The core vision of the project is to create a pioneering manufacturing landmark that goes beyond formality, shaping a new identity for the industry.

中国制造业正以创新驱动的形象在全球市场崭露头角，逐步实现从“中国制造”向“中国品牌”的升级。本项目的核心愿景是以全新姿态打造一个不仅限于形式、还能塑造身份的制造业先锋地标。

Since 2020, the team has provided integrated architectural, interior, and landscape design for the project and taken full responsibility for design and project management overseeing the entire process from concept to completion. After more than four years of construction the project is expected to be fully operational in February 2024.

自 2020 年起，团队为该项目提供建筑、室内和景观的一体化设计，并全面负责设计与项目管理，涵盖从概念到落地的全过程。项目历时四年多建设，已于 2024 年 2 月正式投入使用。

2020 - 2024

Site Area - 33,334 sqm
Gross Floor Area - 91,208 sqm

占地面积 33,334 平方米
建筑面积 91,208 平方米

Scope of Work
Main Designer
Project Management

工作范围
项目设计
项目管理

Project status
Completed

项目进展
已完成



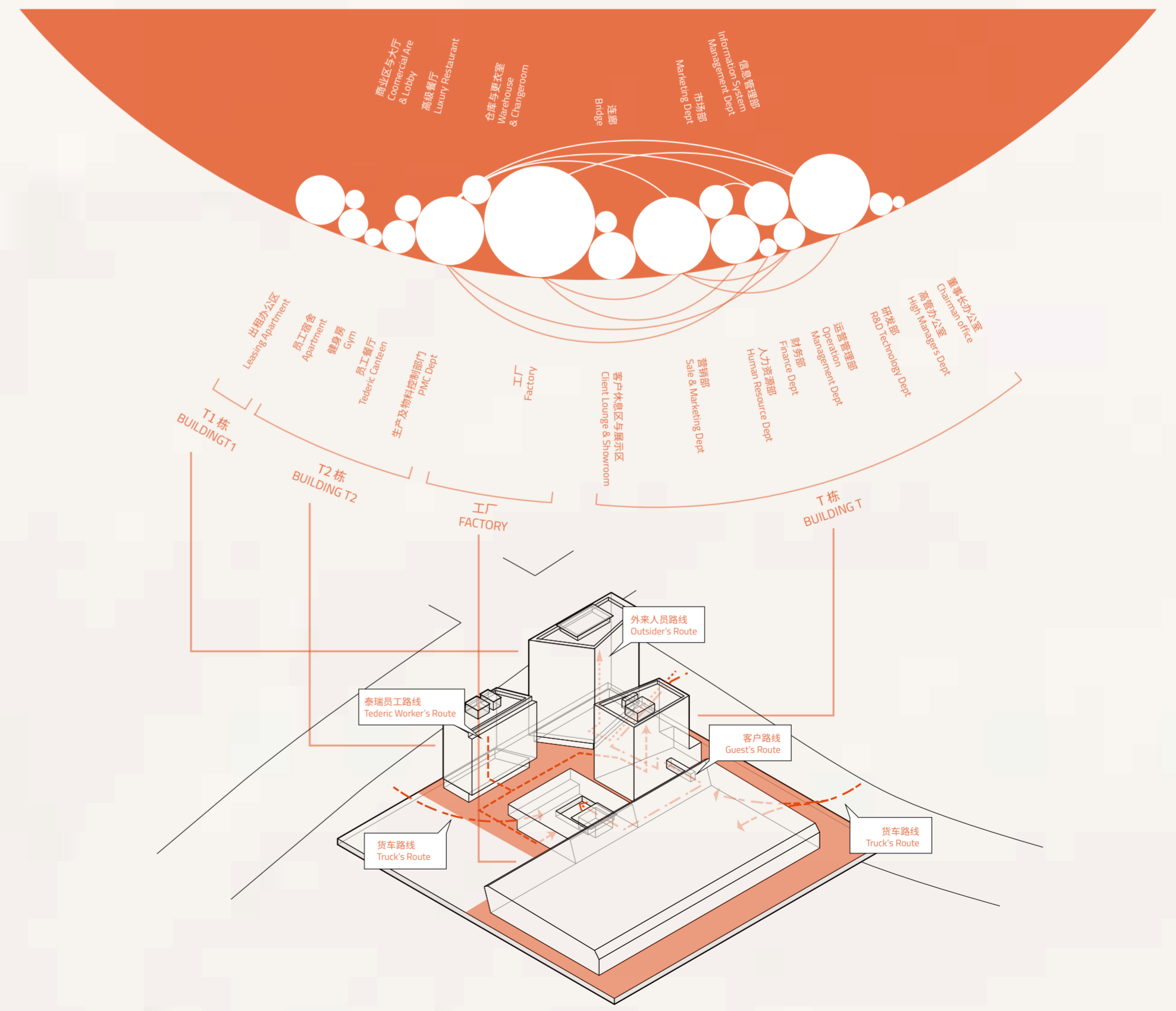
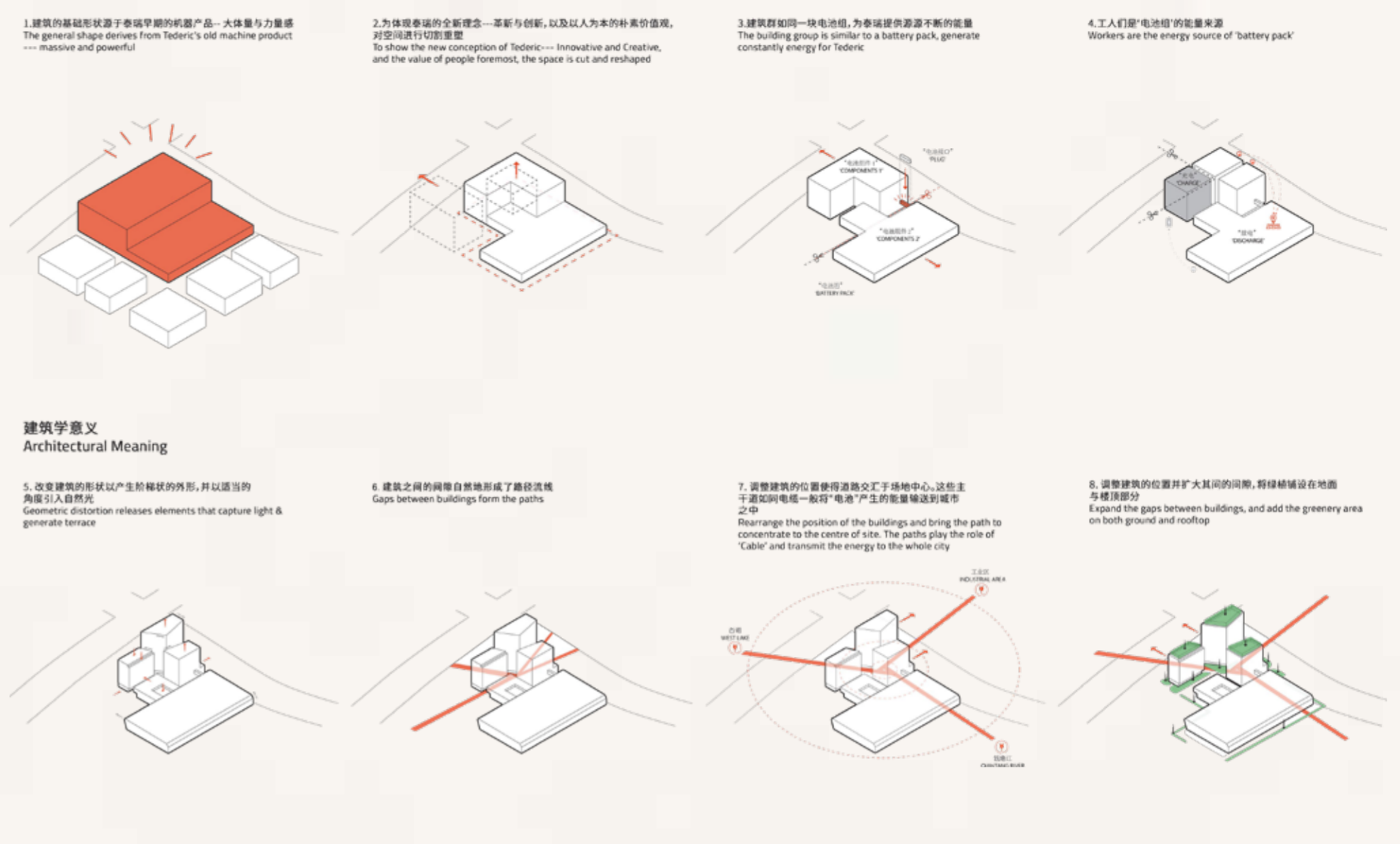
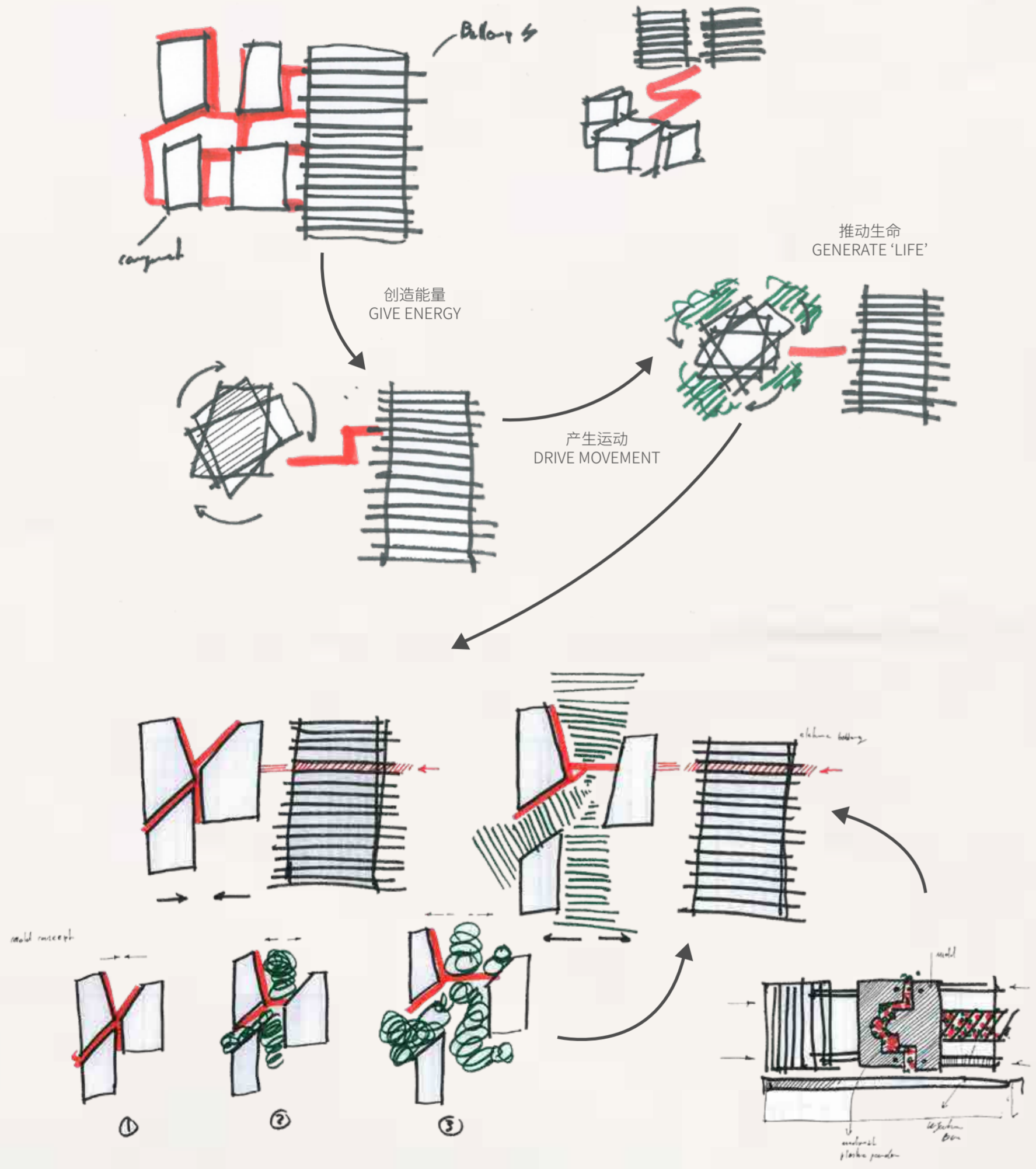

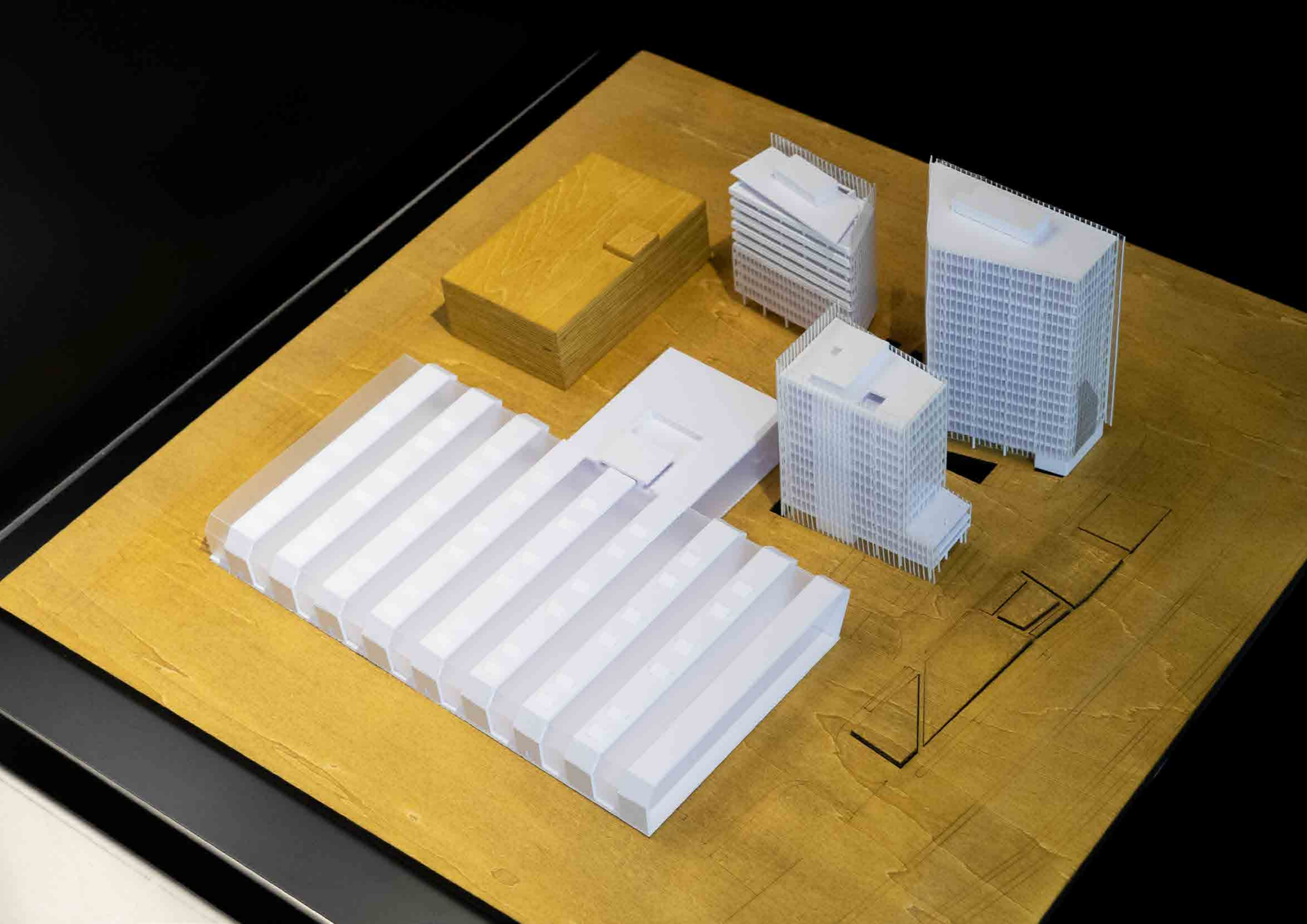













Hangzhou Yiji Headquarters parks

杭州·一季时装总部园区

The current urban planning has comprehensively met the growing social and living needs of the surrounding residents, creating a tightly connected urban service network. However, as socially responsible enterprises, it is important to actively promote positive lifestyles and contribute to the sustainable development of the community.

目前的城市规划已全面满足周边居民日益增长的生活需求，构建了一个紧密的城市服务网络。然而，作为具有社会责任感的企业，应在此基础上积极推动良好的生活方式，助力社区的可持续发展。

In this context, the concept of "Brand Community" has emerged, emphasizing integration with the surrounding social service systems. It focuses on introducing innovative functions and optimizing existing facilities, reflecting the brand's social responsibility, and enhancing social services to maximize social value.

在这一背景下，“品牌园区（Brand Community）”的设计理念应运而生，强调与周边社会服务体系融合，通过创新功能和优化设施，体现品牌的社会责任，并推动社会服务提升，最大化社会价值。

2024 -

Site Area - 14,470 sqm
Gross Floor Area - 41,665 sqm

占地面积 14,470 平方米
建筑面积 41,665 平方米

Scope of Work
Main Designer

工作范围
项目设计

Project status
Construction Documentation

项目进展
深化设计



MOUNTAIN :

- REACH THE ELEVATION WITH A NATURAL APPROACH ... VERTICAL SURFACES ALTERNATE WITH PATHS
- NATURAL PROJECT INTEGRATION
- SENSE OF "SPACE CURIOSITY" "SPACE AMAZEMENT"



FABRIC :

- CULTURAL COMPLEX MESH OVERLAPING
- ALL ASPECT OF HUMAN CULTURE
- "WE SAW THE MESH" ... WE HAVE SENSIBILITY TO UNDERSTAND THE HUMAN LINK
- HUMAN LIFE ACTIVETS CONNECTION

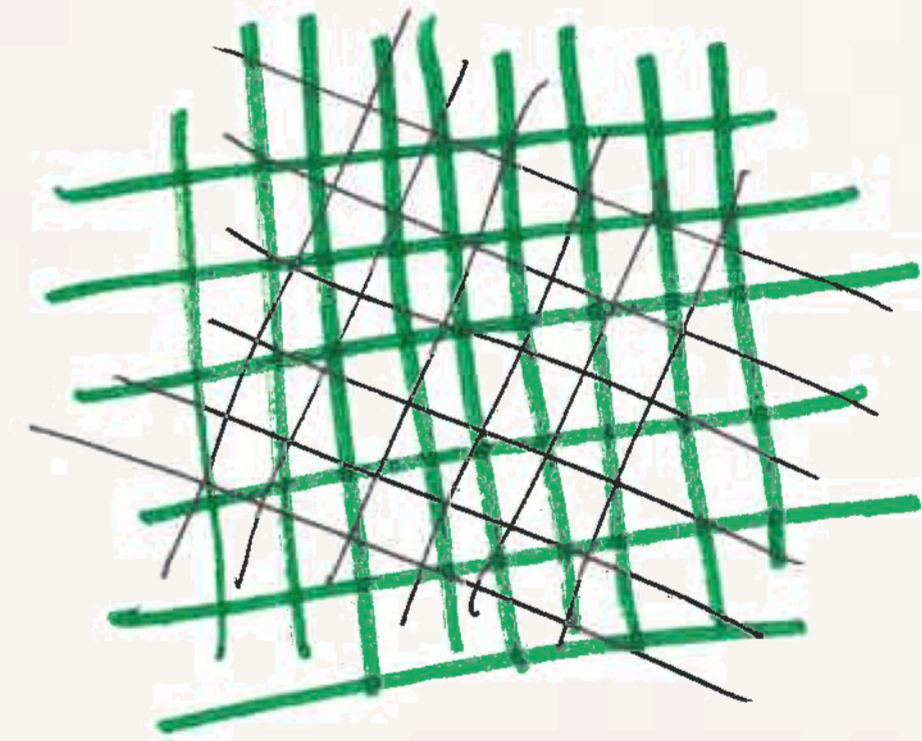
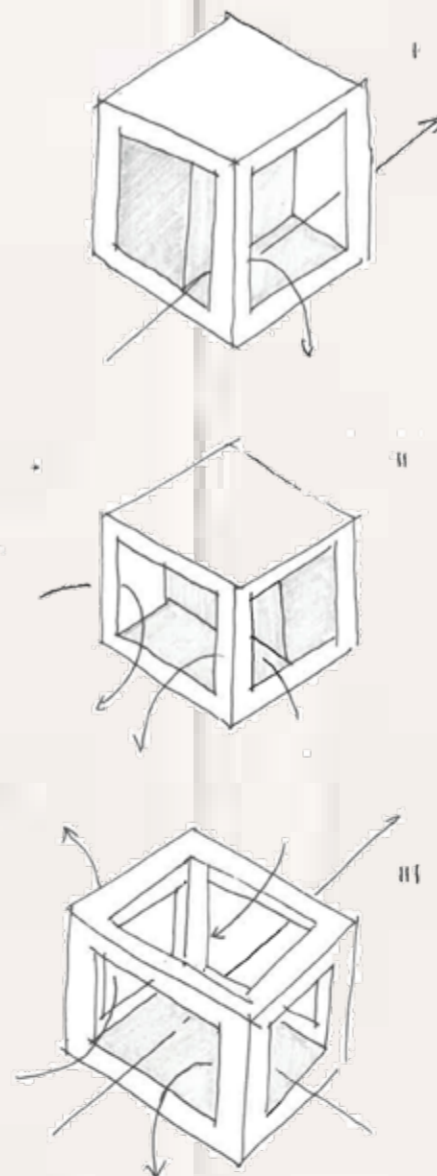









Hangzhou Villa Moon

杭州·月下餐厅

2022 - 2023

Site Area - 300 sqm

Gross Floor Area - 862 sqm

Scope of Work

Main Designer

Project Management

Project status

Completed

占地面积 300 平方米

建筑面积 862 平方米

工作范围

项目设计

项目管理

项目进展

已完成

The concept of Villa Moon is inspired by the scene described in “Drinking under the Moon” by Li Bai, a poet of the Tang Dynasty: “You must drink fine wine, and ride the moon to get drunk on the high platform”. Based on the characteristics of traditional Chinese culture, combined with modern urban lifestyle.

月下餐厅的概念灵感源自唐代诗人李白《月下饮酒》中所描述的场景：“且须饮美酒，乘月醉高台”，意在营造远离城市喧嚣，享受自然馈赠的恬淡闲适氛围。以中国传统文化的特质为概念基础，结合现代都市生活方式。

The urban context around the restaurant, the constant alternation of “traditional” and “modern” architectural languages also happens to place the project at a fairly central location. Therefore, the project building adopts a “double-sided” organizational design. The west side overlooks the inner lanes of the historic district: the traditional language of white brick walls and black terracotta tiles are preserved; the east side faces Lishui Road, supplemented by modern architectural language.

环绕餐厅周边的城市文脉，“传统”与“现代”的建筑语言的不断交替，也恰巧将项目置于相当中心的位置。因此，项目建筑采用“双面”组织设计，西侧俯瞰历史街区的内侧巷道：保留了白砖墙的传统语言和黑色陶瓦；东侧面向丽水路，辅以现代化建筑语言。











Ningbo Hangar35 Moto-Pub

宁波·Hangar35 摩托俱乐部

2023 - 2024

Site Area - 325 sqm

Gross Floor Area - 552 sqm

Scope of Work

Main Designer

Project Management

Project status

Completed

占地面积 325 平方米

建筑面积 552 平方米

工作范围

项目设计

项目管理

项目进展

已完成

"Hangar 35" is a multifunctional pub centered around motorcycle culture, combining dining, a bar, and a motorcycle supply station, attracting and serving motorcycle enthusiasts. The design not only highlights the owner's identity as a motorcycle lover, but also serves as a model for the renovation of the surrounding industrial park. By integrating motorcycle culture, it injects trendy and personalized commercial vitality into the area.

“Hangar 35”是一个以摩托文化为核心的多功能集合俱乐部，集餐饮、酒吧、摩托车补给站于一体，吸引并服务摩托爱好者。设计不仅强调了业主摩托爱好者的身份，更是作为其所在工厂园区更新的典型代表，通过融入摩托文化，为园区注入了新潮与个性化的商业活力。



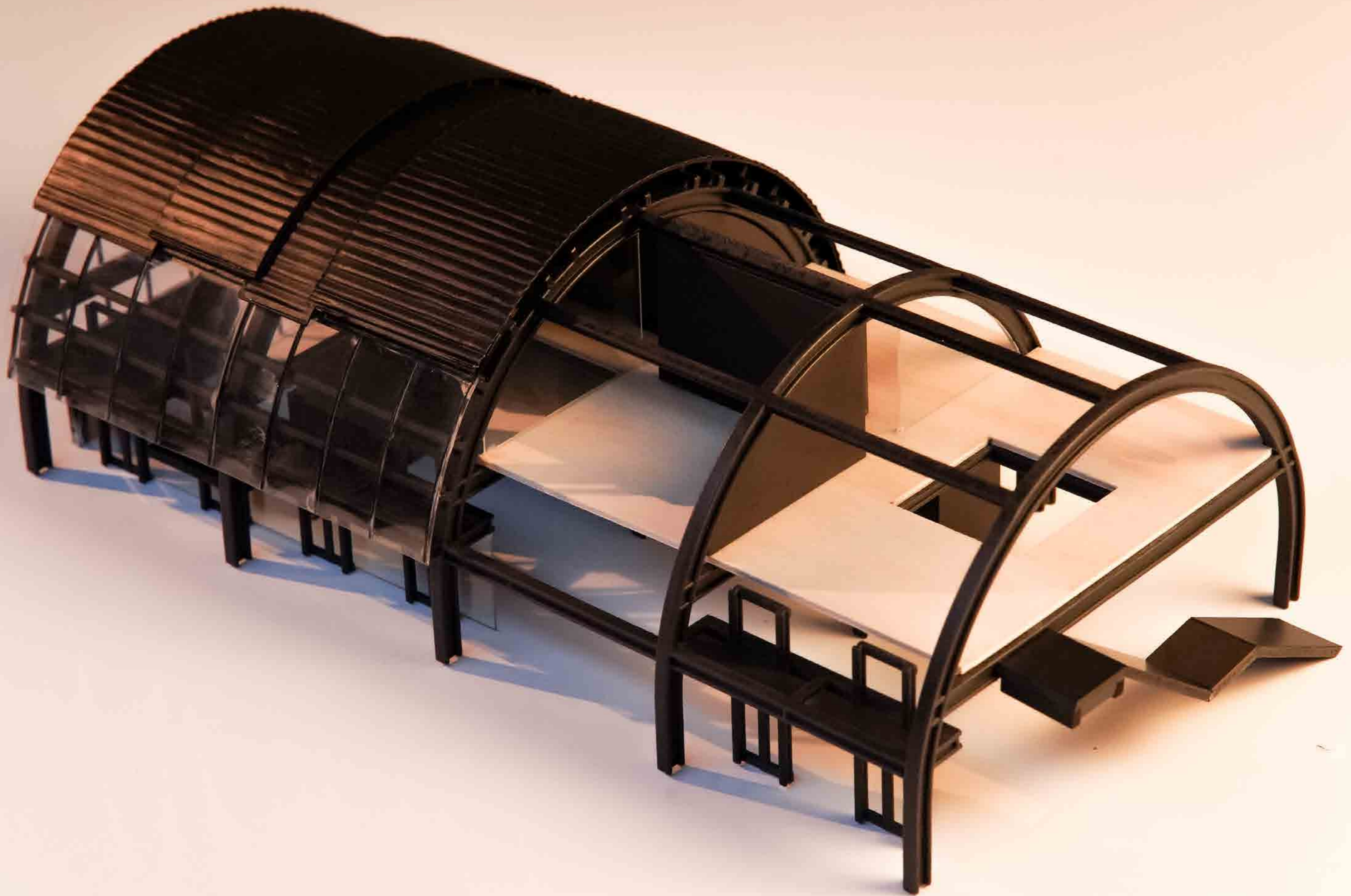



Harley-Davidson

1

2

3

4

Harley-Davidson







Underbridge Station · Floating Tangerine

桥下驿 · 渔越橙桥

Based on the analysis of the surrounding demand and unique connection points, this project aims to "Illuminate Urban Grey Spaces and Connect Riverside Fishing Industrial Memories." It will enhance the area through three main aspects: functional planning, landscape iteration, and architectural supplementation, comprehensively improving community functions and bringing new vitality to the region.

基于场地周边需求及特色连接点的分析，本项目以“点亮城市灰色空间，连结江畔渔工业记忆”为主旨，从功能规划、景观迭代、建筑补充三大方面进行完善，全面提升社区功能，赋予本区域全新生命力。

Based on the analysis of the surrounding demand and unique connection points, this project aims to "Illuminate Urban Grey Spaces and Connect Riverside Fishing Industrial Memories." It will enhance the area through three main aspects: functional planning, landscape iteration, and architectural supplementation, comprehensively improving community functions and bringing new vitality to the region.

我们在本方案中严格遵循任务书中规定的每平方米500元的建造费用进行设计，确保项目既具有成本效益又能达到预期的功能与美学标准，希望为城市诸多废弃空间的解决提供一定贡献。

2024

“Underbridge Space Innovation Design Competition”
Excellence Award

Organizer
Zhejiang Provincial Department of Housing and Urban-Rural Development

“桥下空间创新设计大赛”
佳作奖

主办方
浙江省住房和城乡建设厅











N.61 Quandong, 85 Shuguang Rd., Xihu Dist, Hangzhou, Zhejiang

浙江省杭州市西湖区曙光路 85 号泉东区 61 幢

+86 153 8119 8061

pr@milanesipaiusco.com